



TENNESSEE DEPARTMENT OF ENVIRONMENT AND CONSERVATION
DIVISION OF WATER RESOURCES

Land-Based System Unit
William R. Snodgrass – Tennessee Tower
312 Rosa L. Parks Ave., 11th Floor
Nashville, TN 37243-1102

PERMIT FOR CONSTRUCTION OF SUBSURFACE SEWAGE DISPOSAL SYSTEM

Issued to: <u>Melissa Askins</u> (Owner, Developer, Contractor, Installer, etc.) Location: <u>Victor J. Young Rd. + Goodwin Rd.</u> <u>Rock Island TN 39581</u> Installation: <input checked="" type="checkbox"/> 1. New Installation <input type="checkbox"/> 2. Repair to Existing System Establishment: <input checked="" type="checkbox"/> 1. Residential: # Bedrooms <u>3 (Three)</u> <input type="checkbox"/> 2. Other: _____ (Specify) Gals/Day _____	Evaluation Based Upon: <input type="checkbox"/> 1. Soil typing by Soil Scientist <input type="checkbox"/> a. General <input type="checkbox"/> b. High Intensity <input type="checkbox"/> c. Extra high Intensity <input type="checkbox"/> 2. Soil Percolation Test <input checked="" type="checkbox"/> 3. DWR/LBS Staff Member Estimated Absorption Rate: <u>75</u> MPI	Type of System <input checked="" type="checkbox"/> 1. Conventional <input type="checkbox"/> 2. Modified Conventional <input checked="" type="checkbox"/> 3. Conventional System Substitute <input checked="" type="checkbox"/> Chamber <input checked="" type="checkbox"/> Poly Expanded Styrene <input checked="" type="checkbox"/> Large Diameter Gravelless Pipe <input checked="" type="checkbox"/> Sand Backfill required <input type="checkbox"/> 4. Low Pressure Pipe <input type="checkbox"/> 5. Mound <input type="checkbox"/> 6. Lagoon <input type="checkbox"/> 7. Subsurface Drip System <input type="checkbox"/> 8. Other: _____
	Approval based upon: Statute No.: <u>T.C.A. §68-221-403</u> <input type="checkbox"/> (c) Percolation test <input type="checkbox"/> (d) Grandfather clause, Current standards except those specified <input type="checkbox"/> (f) 12" (karst) and 6" (non-karst) buffer required <input type="checkbox"/> (i) 9" buffer required (24"-36" total soil depth) <input type="checkbox"/> (k) Grandfather clause – meets June 30, 1990 standards (repair only) <input checked="" type="checkbox"/> Other: <u>Current Regs</u>	

This system shall consist of a two compartment septic tank holding 900 gallons with 370 linear feet in needed trenches, 36 inches wide and 24 inches deep. (Depth of gravel: 12 inches)

Also required:
 1. Soil Improvement Practice (SIP)
 2. Flow Diversion Valve
 3. Sewage Pump
 4. Other: _____

All installers of subsurface sewage disposal systems must hold a valid annual license from the Tennessee Department of Environment and Conservation

The recipient of this permit agrees to construct or have constructed the above described system in accordance with T.C.A. §68-401 et seq., and the Regulations to Govern Subsurface Sewage Disposal Systems. If any part of the system is covered before being inspected and approved, it shall be uncovered by the recipient of the permit at the direction of personnel of the Department of Environment and Conservation. Any cutting, filling or alterations of the soil condition on the aforementioned property after this day may render this approval null and void.

 (Signature of Recipient) Date 9/14/17

Issued at McMinnville Tennessee, in Warren Co.
 by Michael J. Gullett Env. Sc. Date 8-25-17
 (Name and Title) (Date of Issue)

This permit is valid for 3 years from date of Issue.

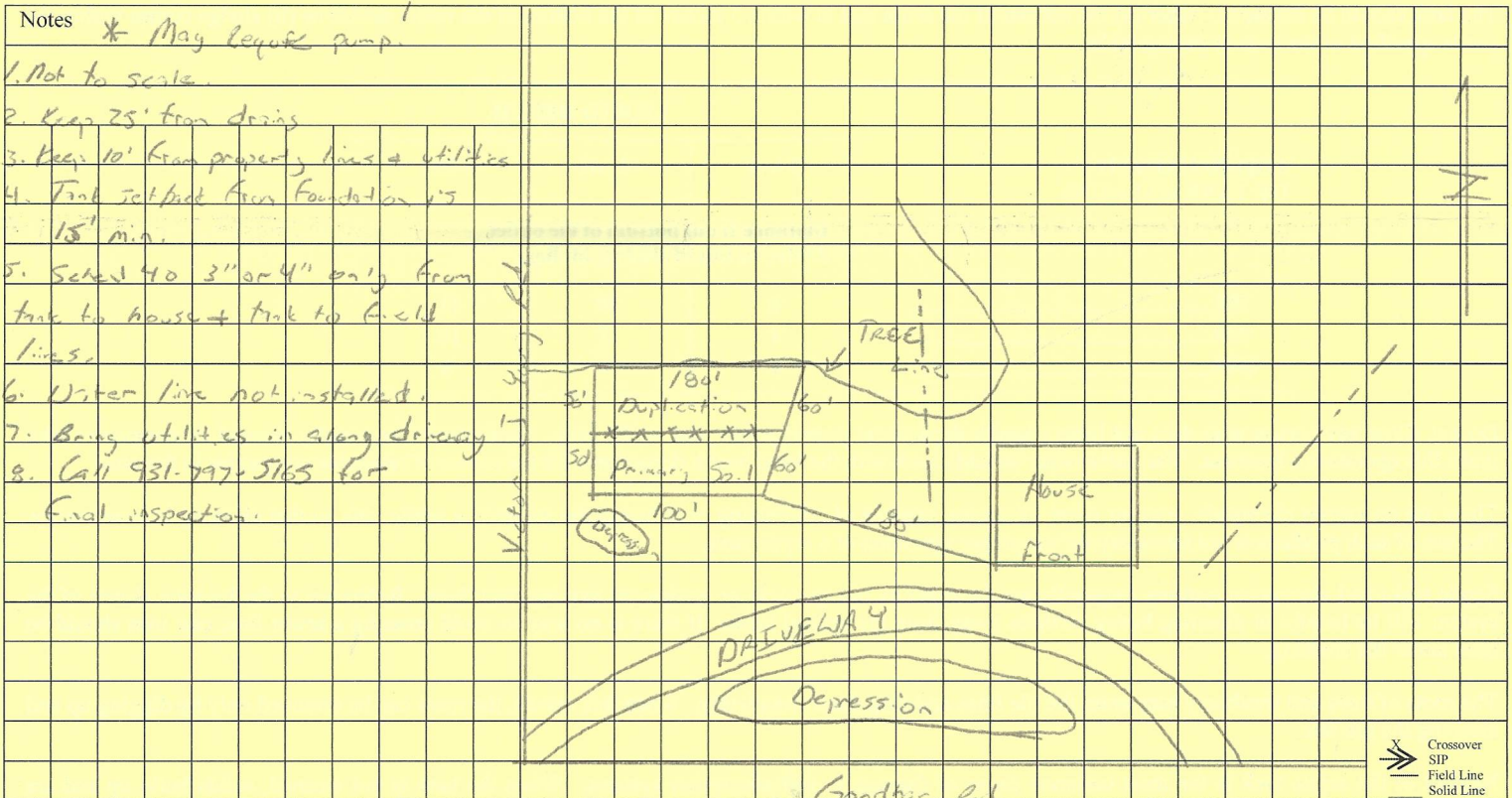

X Crossover
 SIP
 Field Line
 Solid Line